

# USER MANUAL

## LAWN SCARIFIER/AERATOR LS380-GX200

**CAUTION:** Before using our scarifier please read this manual carefully which has been purposely drawn up to provide you with all the necessary information for proper use, in compliance with basic safety require.

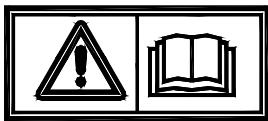

**Caution:** Read carefully the manual before use.



**Caution:** Keep other people well away from the danger area.



**Caution:** Risk of hand and feet injuries.

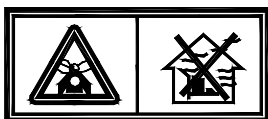

**Caution:** Emission of toxic gas, do not use  
The mower in a close area or not well ventilated.



**Caution:** hot surfaces.

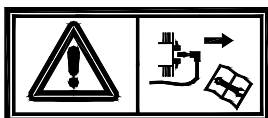

**Caution:** Before carrying out any operation stop the engine and disconnect the spark plug cap.

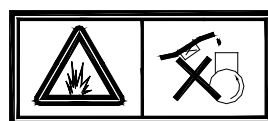

**Caution:** Never fill up the fuel tank while the engine is running.

1- Main components-----	3
2- Assembly-----	3
Assemble the equipment as shown in the illustration section (picture A).	
3- Oil filling (picture B)-----	3
4- Petrol filling-----	4
5- Setting the cutting height (picture C)-----	4
6- Starting the engine.(Picture D)-----	5
7- Turn the engine off-----	5
8- Operations (Picture E)-----	5
9- Installing and removing the grass catcher.(Picture P-G)-----	6
10- Assembly the scarifier roller (Picture H-I)-----	6
11- Faults and remedies-----	7

## 1 Main components

1 Chassis    2 Engine    3 Inferior handle    4 Coupling lever    5 Superior handle  
6 Grass catcher    7 Security wrench

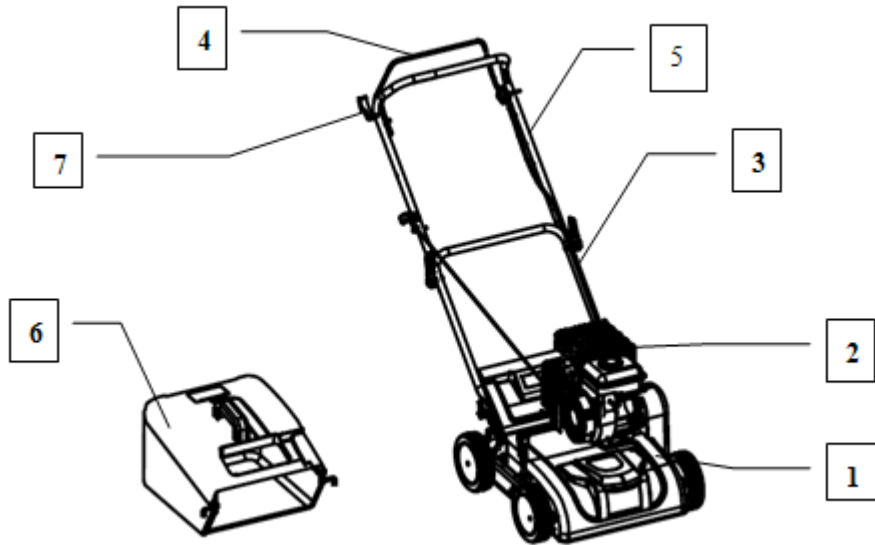

## 2 Assembly

Assemble the equipment as shown in the illustration section (picture A).



**Picture A**

Open out the handle and screw the handles parts with the two screws and red plastic nuts. Then lock two star nuts. Put the recoil starter on the right of the handle and fix the cable with the plastic collar. Introduce the rope of the recoil starter handle on its support guide rope.

## 3 Oil filling (Picture B)

**Engine delivered without oil: add 0.5liter of oil before starting the engine.**

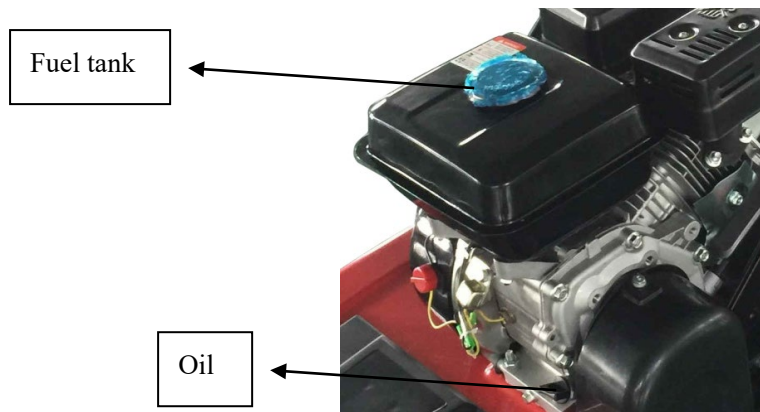

Picture B

#### 4 Petrol filling

**WARNING: GASOLINE IS HIGHLY INFLAMMABLE.**

- Keep gasoline in a jerry can specially made for this purpose.
- Fill up the tank with a funnel, do the operation outside. Do not smoke. Do not use mobile phone.
- Fill up with gasoline and oil before starting the engine. Never open the cap of the fuel tank to add gasoline while the engine is running or still hot.
- Do not start the engine if there is some gasoline spread around, take the mower away from the one where gasoline have been split and avoid any contact from a hot source as long as the split gasoline is completely evaporated.
- Tighten the fuel tank cap and close tightly the jerry can cap.

#### 5 Setting the cutting height (Picture C)



Set the cutting height by the top adjuster knob up or down so that the blade or rake comb the grass without touching the soil.

(Working height position: 8 stages, -8 ~ +10mm)

Picture C

Picture C

## 6 Starting the engine (Picture D)

Engine delivered without oil and fuel: Fill up with unleaded gasoline and oil before starting the engine.

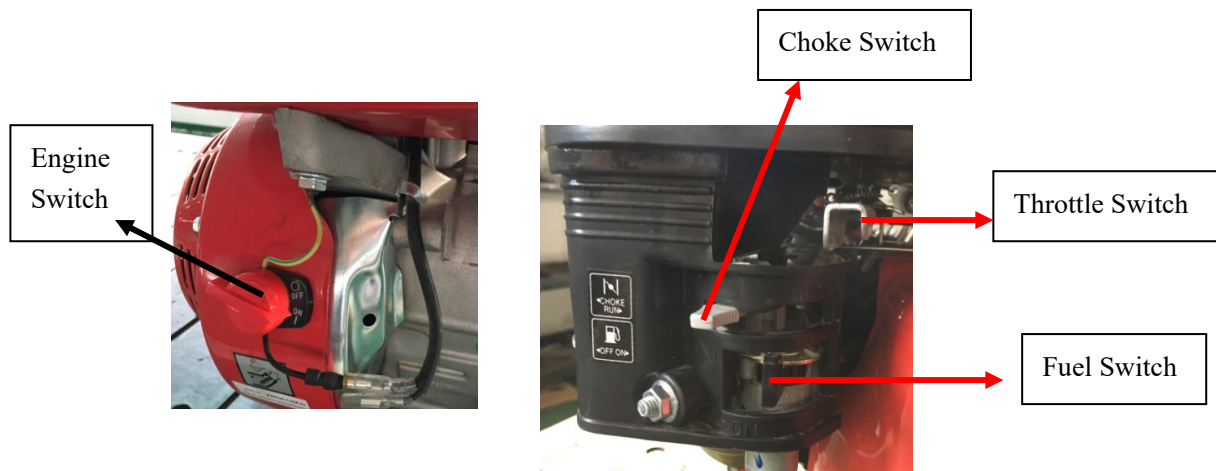

Picture D

- Turn engine switch to **ON** position.
- Turn Fuel Switch to **ON** position by pushing knob.
- Move the choke switch to the **OFF** position.
- Pull the recoil starter handle gently until it engages the give it a good strong pull to start the engine.
- When the engine has started, chock switch need to push to **ON** position.
- When the machine working, you can adjust the throttle switch to adjust the engine speed.

## 7 Turn the engine off

- Always stop the engine and wait for the rotating blades to stop. If not, you can involve danger for your safety and can involve damage to the mower.
- Release the coupling lever.
- Turn engine switch to **OFF** position when the blade stop.

## 8 Operations (Picture E)

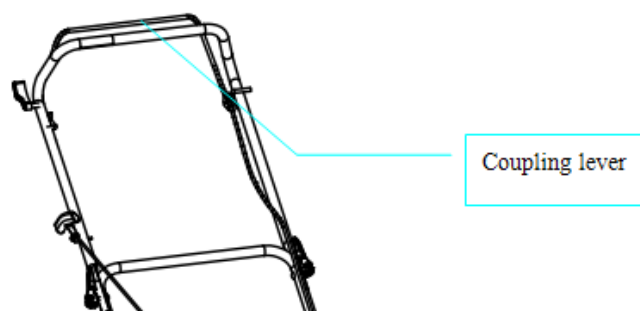

## Picture E

- Hold the coupling lever to drive the blades after starting.
- The appliance must be correctly assembled before use.
- Before use carefully check the appliance for signs of damage. If you notice any defect do not operate it and take it to your local hardware store for repair.
- Replace worn or damaged parts with original spare part, as parts not produced by the manufacturer could result in possible injury.
- Before scarifying place the grass catcher in its position.
- Before use, all objects must be removed from the lawn,
- Only work in daylight or sufficiently good artificial light.
- Do not run the engine in an enclosed and/or poorly ventilated area, where gas of the engine contains carbon monoxide, which are dangerous for your health.
- Wear suitable working clothes and non-slip shoes.
- Do not use the appliance when it is raining or when the grass is wet.
- Particular precautions must be taken while appliance on slopes or downing stretches. Mow across the face of slopes, never down or up.
- Turn off the engine if you must leave the appliance unattended, displace or incline it..
- Never lift the rear of the mower while starting the engine and never place your hands and feet underneath the deck while the engine is running.

**WARNING:** After you stopped the engine the blade or rake is still in motion during a few seconds.

## 9 Installing and removing the grass catcher (Picture F--G)

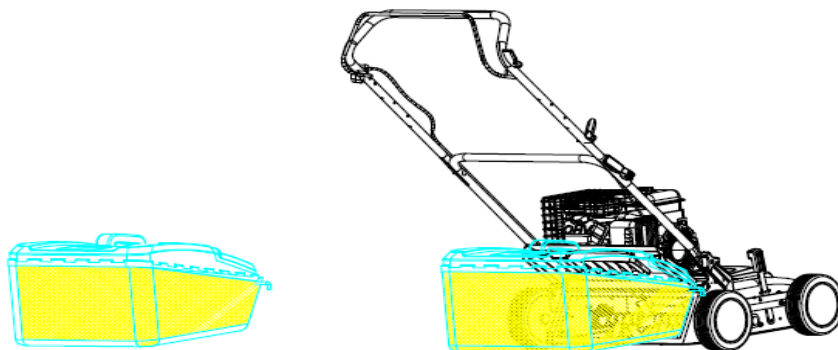

Picture F

Picture G

- a) The grass catcher is installed already Picture F
- b) Pull up the deflector and place the grass catcher at its place. Picture G

## 10 Assembly the scarifier roller and aerating roller (picture H--I)

**Caution! Disconnect the mains and wear protective gloves before handling the blades.**

- Worn blades can impair performance and overload the motor. Before each use, check the condition of the blades and if necessary have them sharpened at your local hardware store.
- Undo the 2 bolts (1) from the underside of the housing by using the supplied hex key.
- Take the scarifier cylinder out of the housing.
- Loosen from the other side the hex nuts 2 and take the cap 3 flange 4 blade 5 and distance rings 6 off the axle 7 in order.
- Make sure that you are wearing protective gloves.
- Slide the hex nut (1) into the driving shaft(2)
- Fix the other side into the housing with the 2 bolts 3.

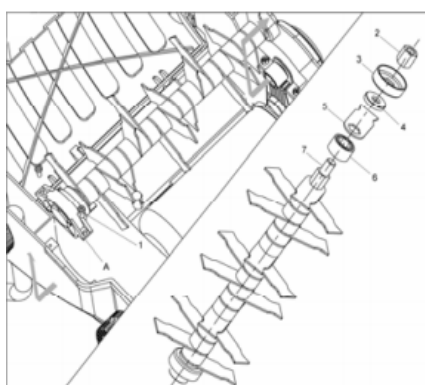

**(Picture H)**

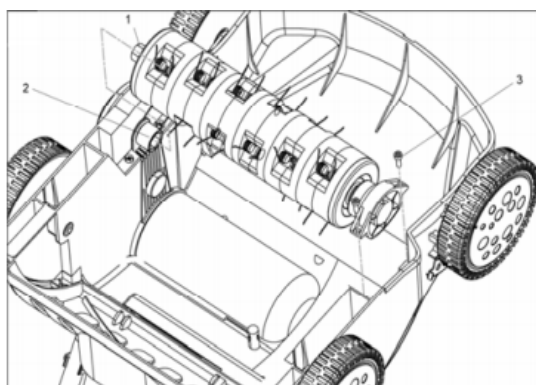

**(Picture I)**

With the rake cylinder, the appliance can be used as a lawn rake for removing matted grass and moss from your lawn. It is recommended that you use the rake attachment every 4-6 weeks, depending on the condition of your lawn.

To achieve good result and to increase the lifetime of the rake cylinder, mow your lawn to a shorter height (less than 4 cm) before starting.

## 11 Faults and remedies

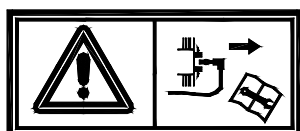

**WARNING:** Stop the engine and disconnect the spark plug lead, before any repairing or maintenance operation.

- For four strokes engine read carefully the maintenance engine manual. Check regularly the oil level and add some oil or replace it if necessary.
- Frequently check the machine and ensure that all grass deposits are removed from beneath the deck.
- Lubricate regularly the wheel axle and the bearings with grease.
- At regularly intervals check the tightening of all bolts and screws. Wear off or badly tightening nuts and bolts can involve some important damages to the engine or the frame.

- If the blade hits violently an obstacle, stop the lawn scarifier and bring it to agreed service station.

Problem	Possible Cause	Remedy
<b>No drive to blades</b>	Broken belt	Repalce belt
	Broken spring tensioner	Replace spring
	Damaged centrifugal clutch	Replace clutch
<b>Poor collection and performance</b>	Blades have become rounded on the bottom edge	Replace blades
	Blade are worn out	
<b>Engine does not start</b>	Spark plug connector not connected	Connect spark plug connector
	Choke lever is not actuated	Actuated the choke
	Feul tank empty	Fill fuel tank
	Fuel line clogged	Clean fuel line
	Defective spark plug	Clean or replace spark plug
	Engine has too much fuel	Dry and adjust spark plug and Start engine
<b>Engine overheats</b>	Low engine oil	Refill immediately
	Impaired cooling	Clean cooling fan
	Air filter clogged	Clean air filter

- If the problem are not remedied, stop the machine and bring it to agreed service station.

**WARNING:**ONLY USE ORIGINAL SPARE PARTS. SPARE PART OF BAD QUALITY CAN INVOLVE IMPORTANT DAMAGES TO YOUR APPLIANCE AND BE PREJUDICIAL FOR YOU SECURITY